

PRODUCT CATALOGUE

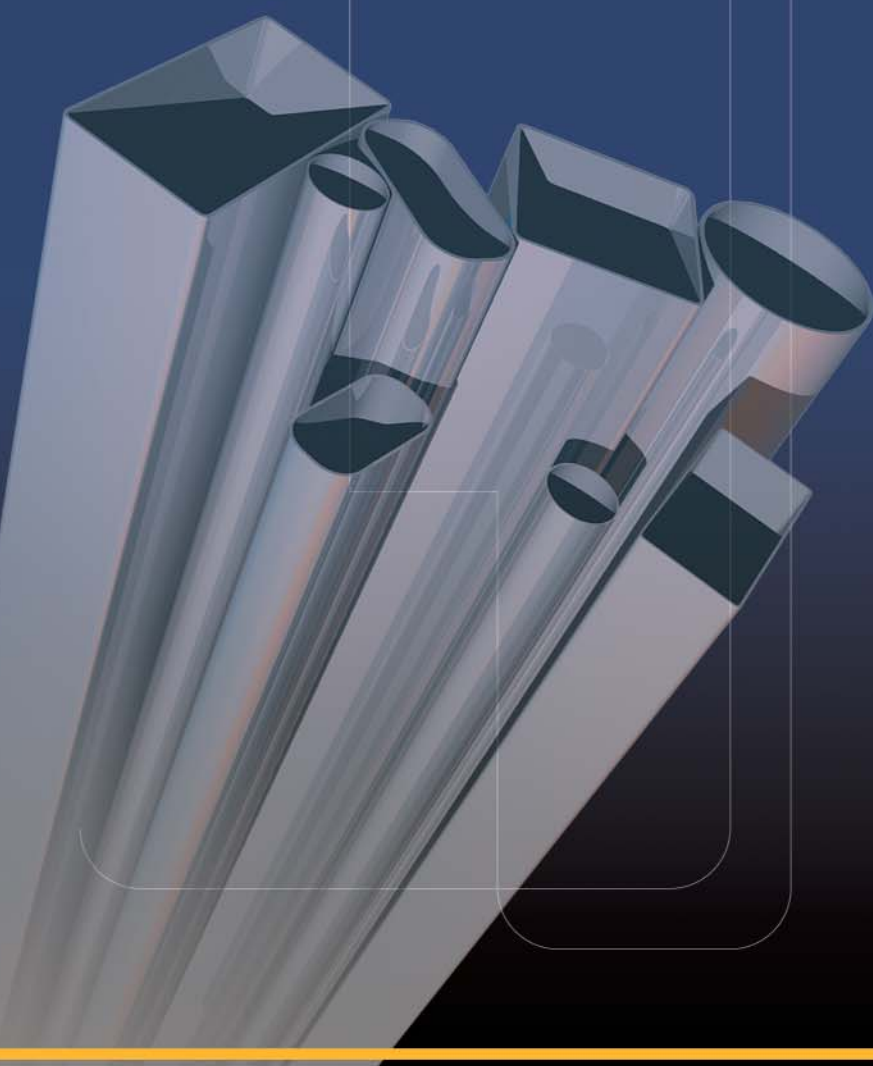

ORTIZ y Cía. S.A.

www.oycnet.com.ar

ROUND

		THICKNESS (mm)														
		0,56	0,60	0,70	0,80	0,90	1,10	1,25	1,40	1,60	1,80	2,00	---	2,50	---	3,20
									1,60	1,80	2,00	2,25	2,50	2,85	3,20	
D (inch)	D (mm)	WEIGHT PER METER (Kg/m)														
3/8	9,52	0.124	0.132	0.152	0.172	0.191	0.228									
-	10,00	0.130	0.139	0.161	0.182	0.202	0.241									
-	12,00	0.158	0.169	0.195	0.221	0.246	0.296	0.331								
1/2	12,70	0.168	0.179	0.207	0.235	0.262	0.315	0.353	0.396	0.445						
-	14,00	0.186	0.198	0.230	0.260	0.291	0.350	0.393	0.442	0.467						
5/8	15,87	0.211	0.226	0.262	0.297	0.332	0.401	0.451	0.500	0.563	0.625	0.684				
-	18,00	0.241	0.257	0.299	0.339	0.380	0.458	0.516	0.573	0.647	0.719	0.789				
3/4	19,05	0.255	0.273	0.317	0.360	0.403	0.487	0.549	0.609	0.689	0.766	0.841				
-	20,00	0.268	0.287	0.333	0.379	0.424	0.513	0.578	0.642	0.726	0.808	0.888				
-	20,64	0.277	0.297	0.344	0.391	0.438	0.530	0.598	0.664	0.751	0.836	0.919				
-	22,00	0.296	0.317	0.368	0.418	0.468	0.567	0.640	0.711	0.805	0.897	0.986				
7/8	22,22	0.299	0.320	0.372	0.423	0.473	0.573	0.646	0.719	0.814	0.906	0.997				
-	25,00	0.338	0.361	0.419	0.477	0.535	0.648	0.732	0.815	0.923	1.030	1.134	1.262	1.387	1.557	1.720
1	25,40	0.343	0.367	0.426	0.485	0.544	0.659	0.744	0.829	0.939	1.048	1.154	1.285	1.412	1.585	1.752
1 1/8	28,57			0.481	0.548	0.614	0.745	0.842	0.938	1.064	1.188	1.311	1.460	1.607	1.808	2.002
1 1/4	31,75		0.461	0.536	0.611	0.685	0.831	0.940	1.048	1.190	1.330	1.467	1.637	1.803	2.031	2.253
-	34,00			0.575	0.655	0.735	0.893	1.010	1.126	1.278	1.429	1.578	1.762	1.942	2.189	2.431
1 3/8	34,92			0.591	0.673	0.755	0.917	1.038	1.157	1.315	1.470	1.624	1.813	1.999	2.254	2.503
1 1/2	38,10			0.646	0.736	0.826	1.004	1.136	1.267	1.440	1.611	1.781	1.989	2.195	2.478	2.754
1 5/8	41,27				0.798	0.896	1.090	1.234	1.377	1.565	1.752	1.937	2.165	2.390	2.700	3.004
1 3/4	44,45				0.861	0.967	1.176	1.332	1.486	1.691	1.893	2.094	2.342	2.586	2.924	3.255
1 7/8	47,62				0.924	1.037	1.262	1.429	1.596	1.816	2.034	2.250	2.518	2.782	3.147	3.505
2	50,80				0.986	1.108	1.348	1.527	1.706	1.941	2.175	2.407	2.694	2.978	3.370	3.756
2 1/4	57,15					1.248	1.521	1.723	1.925	2.192	2.457	2.720	3.046	3.369	3.816	4.258
2 1/2	63,50					1.389	1.693	1.919	2.144	2.442	2.739	3.033	3.399	3.761	4.263	4.759
2 3/4	69,85					1.530	1.865	2.115	2.363	2.693	3.021	3.347	3.751	4.152	4.709	5.260
-	70,00					1.534	1.869	2.119	2.368	2.699	3.027	3.354	3.759	4.162	4.720	5.272
3	76,20					1.671	2.037	2.310	2.583	2.944	3.303	3.660	4.103	4.544	5.155	5.761

HOT ROLLED STEEL
COLD ROLLED STEEL

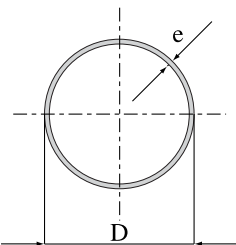

ROUND

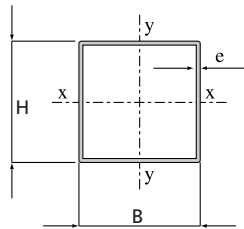

SQUARE

ORTIZ y Cía. S.A.

www.ortizycia.com.ar

SQUARE

		THICKNESS (mm)														
		0,56	0,60	0,70	0,80	0,90	1,10	1,25	1,40	1,60	1,80	2,00	---	2,50	---	3,20
										1,60	1,80	2,00	2,25	2,50	2,85	3,20
B X H (mm)		WEIGHT PER METER (Kg/m)														
10 x 10		0.165	0.176	0.203	0.230	0.256	0.305	0.341								
12 x 12		0.200	0.213	0.247	0.280	0.312	0.374	0.419	0.463	0.519						
15 x 15		0.252	0.270	0.312	0.354	0.396	0.477	0.536	0.594	0.669	0.741					
20 x 20		0.340	0.363	0.422	0.479	0.536	0.649	0.731	0.812	0.919	1.022	1.123	1.246	1.365		
25 x 25			0.457	0.531	0.604	0.677	0.820	0.926	1.031	1.168	1.303	1.435	1.597	1.755	1.970	
30 x 30					0.729	0.817	0.992	1.121	1.249	1.418	1.584	1.747	1.948	2.145	2.414	2.676
35 x 35					0.854	0.958	1.163	1.316	1.468	1.667	1.865	2.059	2.299	2.535	2.859	3.175
40 x 40					0.978	1.098	1.335	1.511	1.686	1.917	2.145	2.371	2.650	2.925	3.303	3.674
45 x 45						1.238	1.507	1.706	1.904	2.167	2.426	2.683	3.001	3.315	3.748	4.173
50 x 50						1.379	1.678	1.901	2.123	2.416	2.707	2.995	3.352	3.705	4.193	4.673
60 x 60						1.660	2.021	2.291	2.560	2.915	3.269	3.619	4.054	4.485	5.082	5.671

HOT ROLLED STEEL
COLD ROLLED STEEL

RECTANGULAR

B x H (mm)	THICKNESS (mm)														
	0,56	0,60	0,70	0,80	0,90	1,10	1,25	1,40	1,60	1,80	2,00	---	2,50	---	3,20
									1,60	1,80	2,00	2,25	2,50	2,85	3,20
B x H (mm)	WEIGHT PER METER (Kg/m)														
10 x 20	0.252	0.270	0.312	0.354	0.396	0.477	0.536	0.594	0.669						
10 x 25	0.296	0.316	0.367	0.417	0.466	0.563	0.634	0.703	0.794	0.882					
10 x 30	0.340	0.363	0.422	0.479	0.536	0.649	0.731	0.812	0.919	1.022					
10 x 40	0.427	0.457	0.531	0.604	0.677	0.820	0.926	1.031	1.168	1.303					
10 x 50			0.640	0.729	0.817	0.992	1.121	1.249	1.418	1.584					
15 x 20			0.367	0.417	0.466	0.563	0.634	0.703	0.794	0.882					
15 x 25	0.340	0.363	0.422	0.479	0.536	0.649	0.731	0.812	0.919	1.022	1.123				
15 x 30			0.476	0.542	0.607	0.734	0.829	0.922	1.043	1.163	1.279	1.422			
20 x 30	0.427	0.457	0.531	0.604	0.677	0.820	0.926	1.031	1.168	1.303	1.435	1.597	1.755		
20 x 40			0.640	0.729	0.817	0.992	1.121	1.249	1.418	1.584	1.747	1.948	2.145		
20 x 50				0.854	0.958	1.163	1.316	1.468	1.667	1.865	2.059	2.299	2.535		
20 x 60				0.978	1.098	1.335	1.511	1.686	1.917	2.145	2.371	2.650	2.925		
20 x 70					1.238	1.507	1.706	1.904	2.167	2.426	2.683	3.001	3.315		
20 x 80					1.379	1.678	1.901	2.123	2.416	2.707	2.995	3.352	3.705		
20 x 100					1.660	2.021	2.291	2.560	2.915	3.269	3.619				
25 x 50				0.916	1.028	1.249	1.414	1.577	1.792	2.005	2.215	2.475	2.730	3.081	3.425
30 x 40				0.854	0.958	1.163	1.316	1.468	1.667	1.865	2.059	2.299	2.535	2.859	3.175
30 x 50			0.858	0.978	1.098	1.335	1.511	1.686	1.917	2.145	2.371	2.650	2.925	3.303	3.674
30 x 60					1.238	1.507	1.706	1.904	2.167	2.426	2.683	3.001	3.315	3.748	4.173
30 x 70				1.228	1.379	1.678	1.901	2.123	2.416	2.707	2.995	3.352	3.705	4.193	4.673
30 x 90					1.660	2.021	2.291	2.560	2.915	3.269	3.619	4.054	4.485	5.082	5.671
40 x 50					1.238	1.507	1.706	1.904	2.167	2.426	2.683	3.001	3.315	3.748	4.173
40 x 60					1.379	1.678	1.901	2.123	2.416	2.707	2.995	3.352	3.705	4.193	4.673
40 x 80					1.660	2.021	2.291	2.560	2.915	3.269	3.619	4.054	4.485	5.082	5.671
50 x 70					1.660	2.021	2.291	2.560	2.915	3.269	3.619	4.054	4.485	5.082	5.671

HOT ROLLED STEEL
COLD ROLLED STEEL

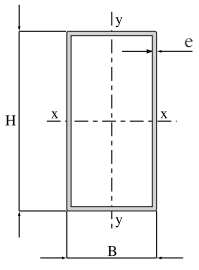

RECTANGULAR

ORTIZ y Cía. S.A.

www.ortizycia.com.ar

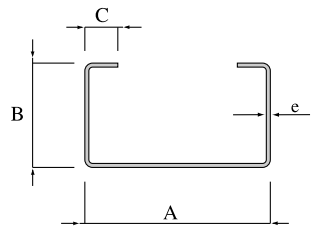

"C" CHANNEL

STRUCTURAL C CHANNELS

B x A x C (mm)	THICKNESS (mm)				
	1,60	1,80	2,00	2,25	2,50
40 x 80 x 15	2.211	2.487	2.736	3.109	3.454
40 x 100 x 15	2.462	2.769	3.077	3.462	3.847
40 x 120 x 15	2.713	3.052	3.391	3.815	4.239
50 x 80 x 15	2.465	2.773	3.081	3.466	3.851
50 x 100 x 15	2.741	3.084	3.427	3.855	4.283
50 x 120 x 15	2.967	3.338	3.709	4.173	4.636

HOT ROLLED STEEL

THE WEIGHTS OF ALL THE TABLES ARE APPROXIMATE AND THEORETICAL; THEY ARE NOT USED FOR BILLING PURPOSES

CLOSED PROFILES

B x L (mm)	THICKNESS (mm)													
	0,60	0,70	0,80	0,90	1,10	1,25	1,40	1,60	1,80	2,00	2,50	3,20		
								1,60	1,80	2,00	2,25	2,50	2,85	3,20
	WEIGHT PER METER (Kg/m)													
BANISTER 26 X 51				0.896	1.090	1.234	1.377	1.556	1.752	1.937				
BANISTER 36 X 57				1.037	1.262	1.429	1.596	1.816	2.034	2.250				
ELLIPTIC 13 x 29	0.320	0.372	0.423	0.473	0.573	0.646	0.719	0.814						
SEMI-OVAL 20 X 54				0.967	1.176	1.332	1.486	1.691	1.893	2.094				
OVAL 14 X 30	0.367	0.426	0.485	0.544	0.659	0.744	0.829	0.939	1.048	1.154				
OVAL 25 x 40			0.673	0.755	0.917	1.038	1.157	1.315	1.470	1.624	1.813	1.999		
OVAL 28 X 60			0.986	1.108	1.348	1.527	1.706	1.941	2.175	2.407	2.694	2.978		
SEMI-OVAL 20 X 55 WING				1.248	1.521	1.723	1.925							
SEMI-OVAL 20 X 50 WING			0.986	1.108	1.348	1.527	1.706							
WINDOW FRAME 28 X 40				1.248	1.521	1.723								
WINDOW FRAME 10 X 40				0.896	1.090	1.234								

HOT ROLLED STEEL
COLD ROLLED STEEL

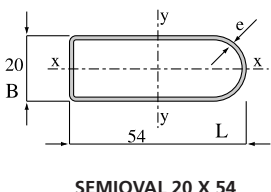
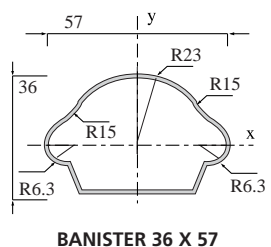
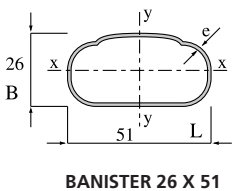
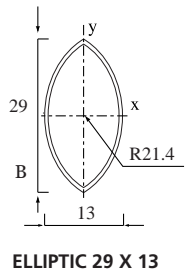
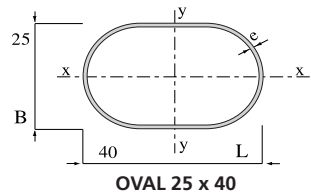
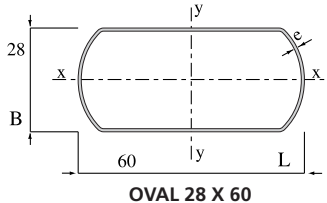
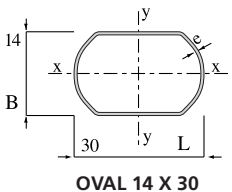

ORTIZ y Cía. S.A.
www.ortizycia.com.ar

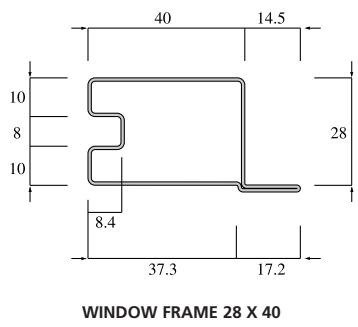
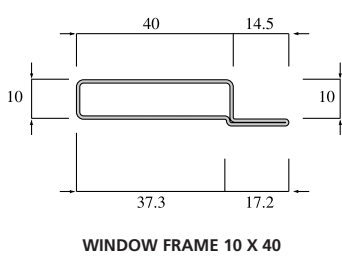
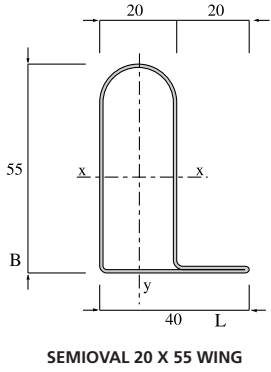
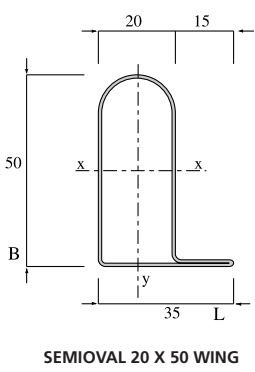

THE WEIGHTS OF ALL THE TABLES ARE APPROXIMATE AND THEORETICAL; THEY ARE NOT USED FOR BILLING PURPOSES

**STEEL PIPE FOR
STRUCTURAL USE**

D (inch)	D (mm)	THICKNESS (mm)				
		2,00	2,25	2,50	2,85	3,20
		WEIGHT PER METER (Kg/m)				
1/2	21.25	0.949	1.054	1.156	1.293	1.424
3/4	26.75	1.221	1.359	1.495	1.680	1.858
1	33.70	1.564	1.745	1.924	2.168	2.407
1 1/4	42.40	1.993	2.228	2.460	2.780	3.094
1 1/2	48.30	2.284	2.555	2.824	3.194	3.559
2	60.30	2.876	3.221	3.564	4.038	4.506
2 1/2	76.10	3.655	4.098	4.538	5.148	5.753

HOT ROLLED STEEL

STANDARD LENGTH: 6.400 mm

**STRUCTURAL
GALVANIZED TUBES**

D (inch)	D (mm)	THICKNESS (mm)						
		0,70	0,80	0,90	1,24	1,60	2,00	2,50
		WEIGHT PER METER (Kg/m)						
5/8	15,87	0.276	0.311	0.346	0.461	0.576		
3/4	19,05	0.334	0.377	0.420	0.561	0.704		
7/8	22,22	0.392	0,443	0.493	0.661	0.832		
1	25,40	0.450	0.509	0.567	0.761	0.961	1.175	
1 1/4	31,75	0.566	0.640	0.714	0.962	1.218	1.495	1.830
1 3/8	34,92		0.706	0.788	1.062	1.346	1.654	2.028
1 1/2	38,10		0.772	0.861	1.162	1.475	1.814	2.227
1 5/8	41,27			0.935	1.262	1.603	1.974	2.426
1 3/4	44,45			1.009	1.363	1.731	2.134	2.625
1 7/8	47,62			1.082	1.463	1.860	2.293	2.824
2	50,80			1.156	1.563	1.988	2.453	3.023
2 1/2	63,50				1.964	2.502	3.092	3.819
3	76,20				2.365	3.016	3.731	4.614



www.ortizyca.com.ar





MANUFACTURING STANDARDS:

Ortiz y Cía. S.A. relies on its manufacturing processes, commercialization and after-sales service of Welded steel tubes (including cut and shaped pieces) and open cold formed steel shapes, certified under ISO 9001-2000 standards which guarantee the reliability of the processes involved in all the stages of the production chain.

THE REFERENCE STANDARDS USED IN THE MANUFACTURING OF ORTIZ Y CÍA. S.A.'S PRODUCTS ARE:

IRAM-IAS-U-500-206-3:	Open cold formed steel shapes for structural purposes.
IRAM-IAS-U-500-2590:	Electric-resistance-welded carbon and alloy steel tubing for mechanical application.
IRAM-IAS-U-500-2592:	Welded carbon steel tubing for structural use.
ASTM A513:	Standard Specification for Electric- Resistance-Welded Carbon and Alloy Steel Mechanical Tubing.

SERVICES FOR OUR CLIENTS:

Ortiz y Cía. S.A. provides a wide range of welded steel tubes and structural C channels. The focus is to satisfy a range of diverse usage possibilities by providing products that strengthen the competitiveness of our customers:

- Standard and Special Lengths (to avoid extra costs in cut to length pieces)
Standard length 6.000 mm :: Special length from 4.000 to 8.000 mm
- Structural C Channels
Standard length 12.000 mm :: Special length from 4.000 to 8.000 mm
- Deburred end cuts
- Cut-to-length pieces with deburred end cuts (Lengths from 30 to 4.000 mm)
- Round, square and rectangular tubes with inner weld bead removed
- Delivery in customer facilities.
- Various types of packaging.
- Assistance in special projects (products, logistics and services).
- New products development.
- Quality assistance.
- The study of tubes with special grades of steels (microalloyed steel / structural steel).
- Sales assistance in Buenos Aires, Córdoba, Santa Fé, Mendoza, San Luis, Salta y Tucumán.



ORTIZ y Cía. S.A.

ORTIZ Y CÍA. S.A
Production, Administration and Sales facilities:
Av. Don Bosco 5195 X5002BLC Córdoba - Argentina
Tel: 54 (351) 4858200 Fax: (351) 4858250
e-mail: info@oycnet.com.ar

www.ortizcia.com.ar

